

Mathias Hooke

Joseph Colwell

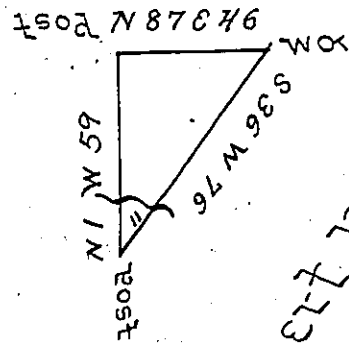

Robert Parks

The above is a Draft of a Piece of Land Surveyed
 April 24th 1806 in pursuance of a warrant granted
 to Henry Hooke dated March 5th 1806. Situate on
 the waters of Mill Creek in ~~the~~ Second Moon
 Township & County of Beaver; Containing 5 Acres
 with allowance of 6 per Cent.

Jas Carothers U.S.

To Samuel Cochran Esq^r }
 Surveyor General }

IN TESTIMONY that the above is a copy of the original remaining on file in
 the Department of Internal Affairs of Pennsylvania, made
 conformably to an Act of Assembly approved the 16th day of
 February, 1833, I have hereunto set my Hand and caused
 the Seal of said Department to be affixed at Harrisburg,
 this thirteenth day of March 1905.

Isaac D. Perry
 Secretary of Internal Affairs.